

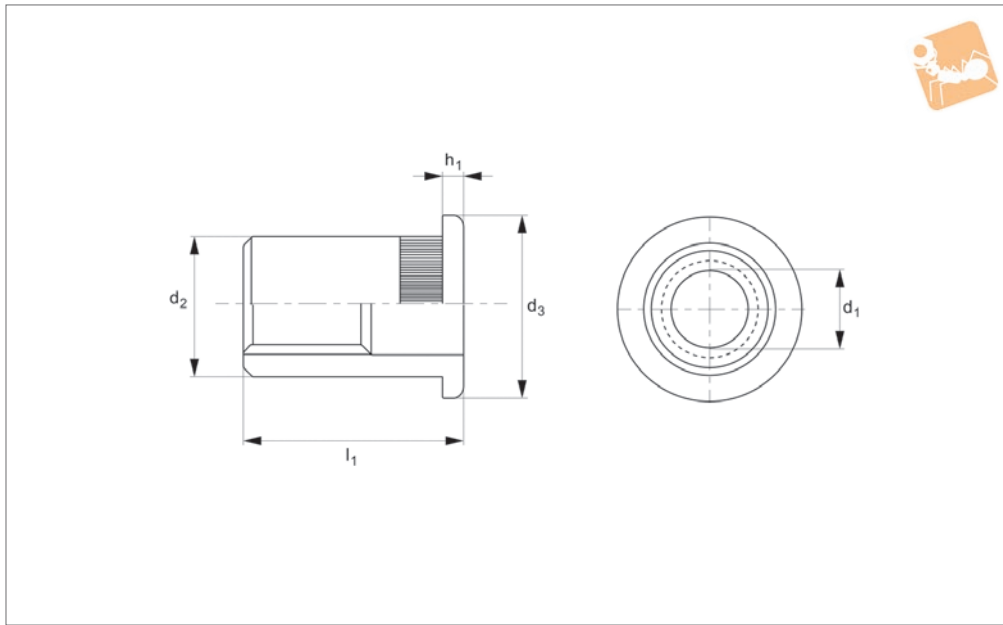

Flange Head Knurled Insert Nuts

A2 stainless

Insert Nuts



P0820.A2

INSERT NUTS

Material

Stainless steel (A2, AISI 303).

Technical Notes

Knurled body type, plain available on request.

Flange head insert nuts are recommended for use in load bearing applications. The larger sized head acts as a reinforcement to the hole and provides resistance to push-out.

The knurled body provides extra turning resistance and the head acts as a spacer.

Tips

Also known as blind rivet nuts or grip nuts.

Order No.	d ₁	Grip range	d ₂ +0 -0.2	d ₃	h ₁	l ₁
P0820.030-020-A2	M 3	0,5-2,0	4.9	8.0	0.8	9.8
P0820.040-025-A2	M 4	0,5-2,5	5.9	9.0	1.0	12.0
P0820.040-040-A2	M 4	2,5-4,0	5.9	9.0	1.0	13.5
P0820.050-025-A2	M 5	0,5-3,0	6.9	10.0	1.0	13.0
P0820.050-055-A2	M 5	3,0-5,5	6.9	10.0	1.0	16.0
P0820.060-030-A2	M 6	0,5-3,0	8.9	12.0	1.5	15.5
P0820.060-055-A2	M 6	3,0-5,5	8.9	12.0	1.5	18.5
P0820.080-030-A2	M 8	0,5-3,0	10.9	15.0	1.5	17.5
P0820.080-055-A2	M 8	3,0-5,5	10.9	15.0	1.5	20.0
P0820.100-035-A2	M10	1,0-3,5	12.9	17.0	2.0	21.0
P0820.100-060-A2	M10	3,5-6,0	12.9	17.0	2.0	23.5
P0820.120-040-A2	M12	1,0-4,0	15.9	23.0	2.0	25.0

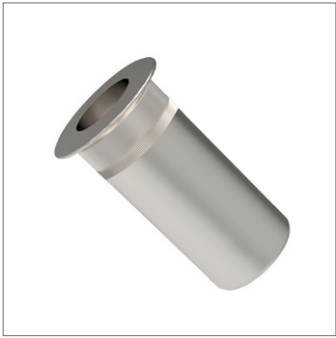

P0820.AL

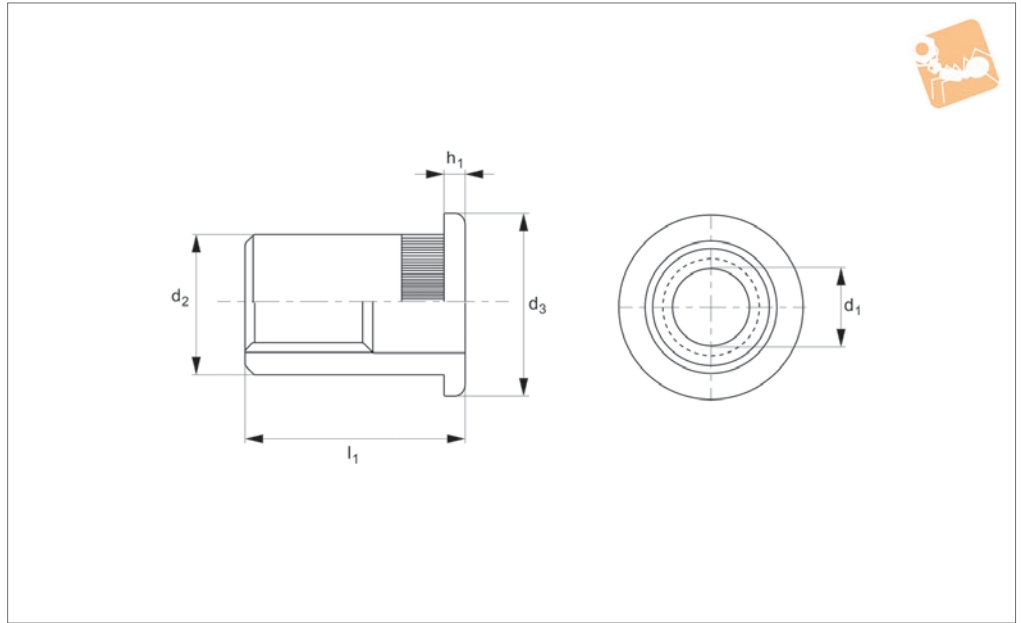

Material
Aluminium.

Technical Notes
Knurled body type, plain available on request.

Flange head insert nuts are recommended for use in load bearing applications. The larger sized head acts as a reinforcement to the hole and provides resistance to push-out.

The knurled body provides extra turning resistance and the head acts as a spacer.

Tips
Also known as blind rivet nuts or grip nuts.

Order No.	d ₁	Grip range	d ₂ +0 -0.2	d ₃	h ₁	l ₁
P0820.030-025-AL	M 3	0,5-2,5	4.9	7.0	0.8	10.5
P0820.030-035-AL	M 3	2,5-3,5	4.9	7.0	0.8	11.5
P0820.040-030-AL	M 4	0,5-3,0	5.9	9.0	1.0	11.0
P0820.040-045-AL	M 4	3,0-4,0	5.9	9.0	1.0	14.0
P0820.050-025-AL	M 5	0,5-3,0	6.9	10.0	1.0	13.0
P0820.050-055-AL	M 5	3,0-5,5	6.9	10.0	1.0	16.0
P0820.050-080-AL	M 5	5,5-8,0	6.9	10.0	1.0	19.0
P0820.060-030-AL	M 6	0,5-3,0	8.9	12.0	1.5	16.0
P0820.060-055-AL	M 6	3,0-5,5	8.9	12.0	1.5	18.5
P0820.060-080-AL	M 6	5,5-8,0	8.9	12.0	1.5	21.0
P0820.080-030-AL	M 8	0,5-3,0	10.9	15.0	1.5	17.5
P0820.080-055-AL	M 8	3,0-5,5	10.9	15.0	1.5	20.0
P0820.080-080-AL	M 8	5,5-8,0	10.9	15.0	1.5	22.5
P0820.080-105-AL	M 8	8,0-10,5	10.9	15.0	1.5	25.0
P0820.100-030-AL	M10	0,5-3,0	11.9	16.0	2.0	19.0
P0820.100-060-AL	M10	3,0-6,0	11.9	16.0	2.0	24.0
P0820.100-090-AL	M10	6,0-9,0	11.9	16.0	2.0	27.0
P0820.100-120-AL	M10	9,0-12,0	11.9	16.0	2.0	30.0
P0820.120-040-AL	M12	1,0-4,0	15.9	22.0	2.0	25.0
P0820.120-070-AL	M12	4,0-7,0	15.9	22.0	2.0	28.0
P0820.120-100-AL	M12	7,0-10,0	15.9	22.0	2.0	31.0



Flange Head Knurled Insert Nuts

Steel, zinc-plated

Insert Nuts

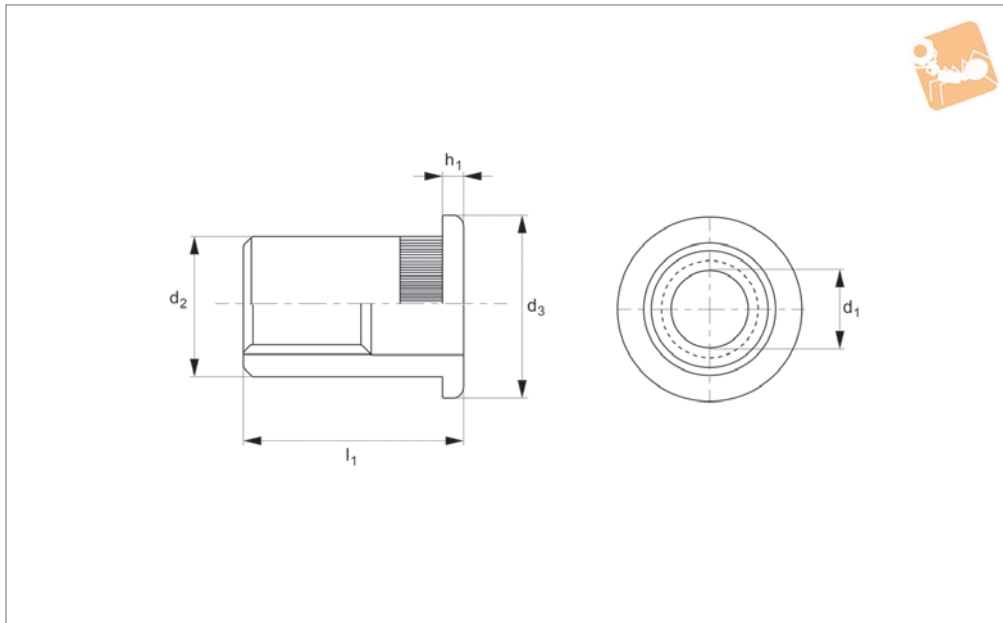

P0820.ZP

INSERT NUTS

Material

Steel, zinc-plated.

Technical Notes

Knurled body type, plain available on request.

Flange head insert nuts are recommended for use in load bearing applications. The larger sized head acts as a reinforcement to the hole and provides resistance to push-out.

The knurled body provides extra turning resistance and the head acts as a spacer.

Tips

Also known as blind rivet nuts or grip nuts.

Order No.	d ₁	Grip range	d ₂ +0 -0.2	d ₃	h ₁	l ₁
P0820.030-025-ZP	M 3	0,5-2,5	4.9	7.0	0.9	10.9
P0820.030-040-ZP	M 3	2,5-4,0	4.9	7.0	0.9	11.5
P0820.040-025-ZP	M 4	0,5-2,5	5.9	9.0	0.9	11.6
P0820.040-055-ZP	M 4	3,0-5,5	5.9	9.0	1.0	14.0
P0820.050-025-ZP	M 5	0,5-2,5	6.9	10.0	1.0	13.0
P0820.060-030-ZP	M 6	0,5-3,0	8.9	12.3	1.3	15.5
P0820.060-055-ZP	M 6	3,0-5,5	8.9	12.3	1.3	19.5
P0820.060-080-ZP	M 6	5,5-8,0	8.9	12.3	1.5	21.0
P0820.080-030-ZP	M 8	0,7-3,0	10.9	16.0	1.5	17.5
P0820.080-055-ZP	M 8	3,0-5,5	10.9	16.0	1.5	20.0
P0820.080-060-ZP	M 8	3,5-6,0	10.9	15.0	1.5	21.0
P0820.080-080-ZP	M 8	5,5-8,0	10.9	15.0	1.6	24.0
P0820.080-105-ZP	M 8	8,0-10,5	10.9	15.0	1.6	25.0
P0820.100-030-ZP	M10	1,0-3,0	11.9	16.0	2.0	19.0
P0820.100-060-ZP	M10	3,0-6,0	11.9	16.0	2.0	24.0
P0820.100-090-ZP	M10	6,0-9,0	11.9	16.0	2.0	27.0
P0820.100-120-ZP	M10	9,0-12,0	11.9	16.0	2.0	30.0
P0820.100-035-ZP	M10	1,0-3,5	12.9	19.0	2.0	21.0
P0820.100-060A-ZP	M10	3,5-6,0	12.9	19.0	2.0	23.5
P0820.120-040-ZP	M12	1,0-4,0	15.9	22.0	2.1	25.0
P0820.120-070-ZP	M12	4,0-7,0	15.9	22.0	2.1	28.0
P0820.120-100-ZP	M12	7,0-10,0	15.9	22.0	2.1	31.0
P0820.050-055-ZP	M 5	3,0-5,5	6.9	10.0	1.0	16.0
P0820.050-080-ZP	M 5	5,5-8,0	6.9	10.0	1.0	19.0



INSERT NUTS



P0821.ZP

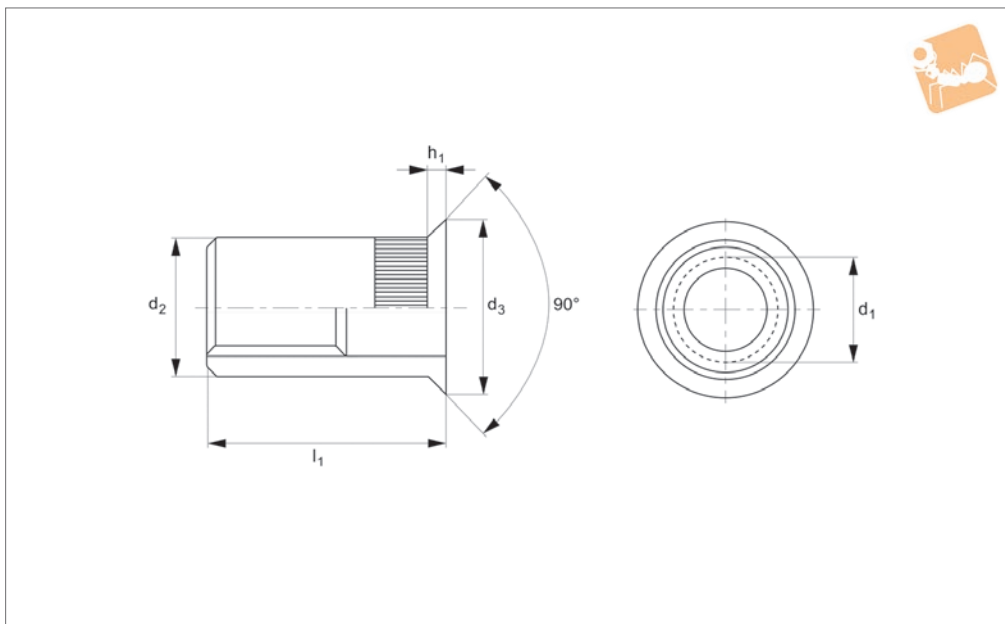

Material

Steel, zinc-plated.

Technical Notes

Knurled body type.

The countersunk head is a stronger type of

head and will ensure a flush finish in a countersunk hole. The knurled body provides extra turning resistance.

Tips

Also known as blind rivet nuts or grip nuts.

Important Notes

Lip Height:

M3-M8: 0<1.5

M10: 1.5<1.7

M12: 1.7<1.9

Order No.	d ₁	Grip range	d ₂ +0 -0.2	d ₃	h ₁	l ₁
P0821.030-035-ZP	M 3	1,5-3,5	4,9	7,5	1,5	11,5
P0821.030-050-ZP	M 3	3,5-5,0	4,9	7,5	1,5	12,5
P0821.040-035-ZP	M 4	1,5-3,5	5,9	8,5	1,5	12,0
P0821.040-065-ZP	M 4	3,5-6,5	5,9	8,5	1,5	15,0
P0821.050-040-ZP	M 5	1,5-4,0	6,9	9,5	1,5	13,0
P0821.050-065-ZP	M 5	4,0-6,5	6,9	9,5	1,5	16,0
P0821.050-090-ZP	M 5	6,5-9,0	6,9	9,5	1,5	18,5
P0821.060-040-ZP	M 6	1,5-4,0	8,9	11,5	1,5	15,5
P0821.060-065-ZP	M 6	4,0-6,5	8,9	11,5	1,5	18,0
P0821.060-090-ZP	M 6	6,5-9,0	8,9	11,5	1,5	20,5
P0821.080-045-ZP	M 8	1,7-4,5	10,9	13,5	1,5	18,5
P0821.080-065-ZP	M 8	4,0-6,5	10,9	13,5	1,5	21,0
P0821.080-090-ZP	M 8	6,5-9,0	10,9	13,5	1,5	23,5
P0821.100-045-ZP	M10	2,0-4,5	11,9	14,5	1,7	21,0
P0821.100-075-ZP	M10	4,5-7,5	11,9	14,5	1,7	24,0
P0821.100-105-ZP	M10	7,5-10,5	11,9	14,5	1,7	27,0
P0821.120-045-ZP	M12	2,0-4,5	15,9	19,0	1,9	24,5
P0821.120-075-ZP	M12	4,5-7,5	15,9	19,0	1,9	27,5
P0821.120-105-ZP	M12	7,5-10,5	15,9	19,0	1,9	31,0



Countersunk Insert Nuts

A2 stainless

Insert Nuts

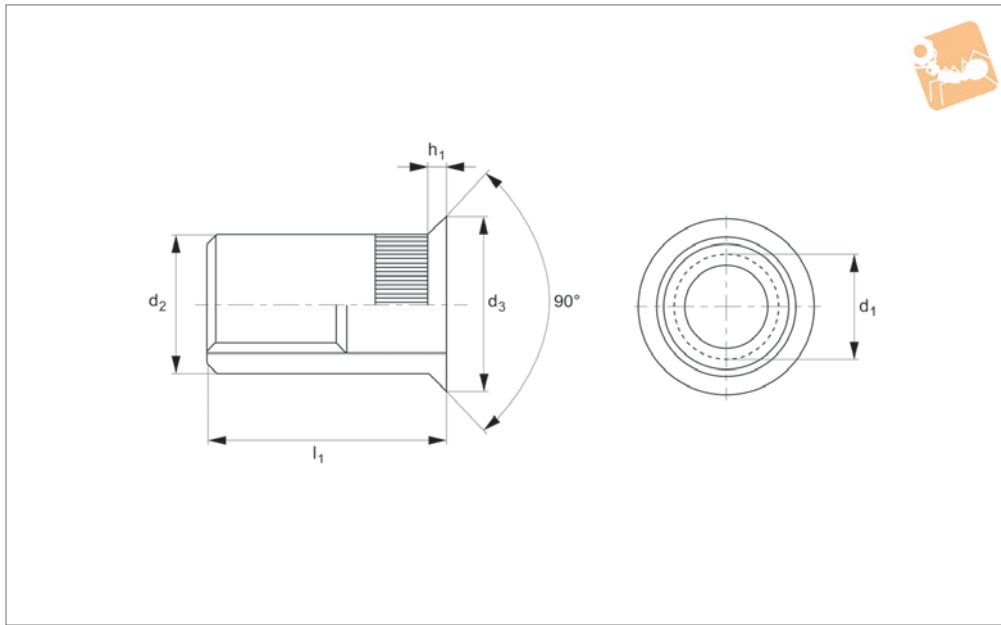

P0821.A2

INSERT NUTS

Material

Stainless steel (A2, AISI 303).

Technical Notes

Knurled body type, plain available on request.

The countersunk head is a stronger type of

head and will ensure a flush finish in a countersunk hole. The knurled body provides extra turning resistance.

Tips

Also known as blind rivet nuts or grip nuts.

Important Notes

Lip Height:

M3-M8: 0<1.5

M10: 1.5<1.7

M12: 1.7<1.9

Order No.	d ₁	Grip range	d ₂ +0 -0.2	d ₃	h ₁	l ₁
P0821.030-035-A2	M 3	1,5-3,5	4.9	7.5	1.5	11.5
P0821.040-040-A2	M 4	1,5-4,0	5.9	8.5	1.5	12.5
P0821.050-040-A2	M 5	1,5-4,0	6.9	9.5	1.5	13.5
P0821.050-065-A2	M 5	4,0-6,5	6.9	9.5	1.5	16.0
P0821.060-045-A2	M 6	1,5-4,5	8.9	11.5	1.5	16.0
P0821.060-065-A2	M 6	4,0-6,5	8.9	11.5	1.5	18.0
P0821.080-040-A2	M 8	1,5-4,0	10.9	13.5	1.5	18.0
P0821.080-065-A2	M 8	4,0-6,5	10.9	13.5	1.5	21.0
P0821.100-045-A2	M10	2,0-4,5	12.9	15.5	1.8	21.0
P0821.100-075-A2	M10	4,5-7,5	12.9	15.5	1.8	24.0
P0821.120-045-A2	M12	2,0-4,5	15.9	19.0	2.0	24.5
P0821.120-075-A2	M12	4,5-7,5	15.9	19.0	2.0	27.5



P0821.AL

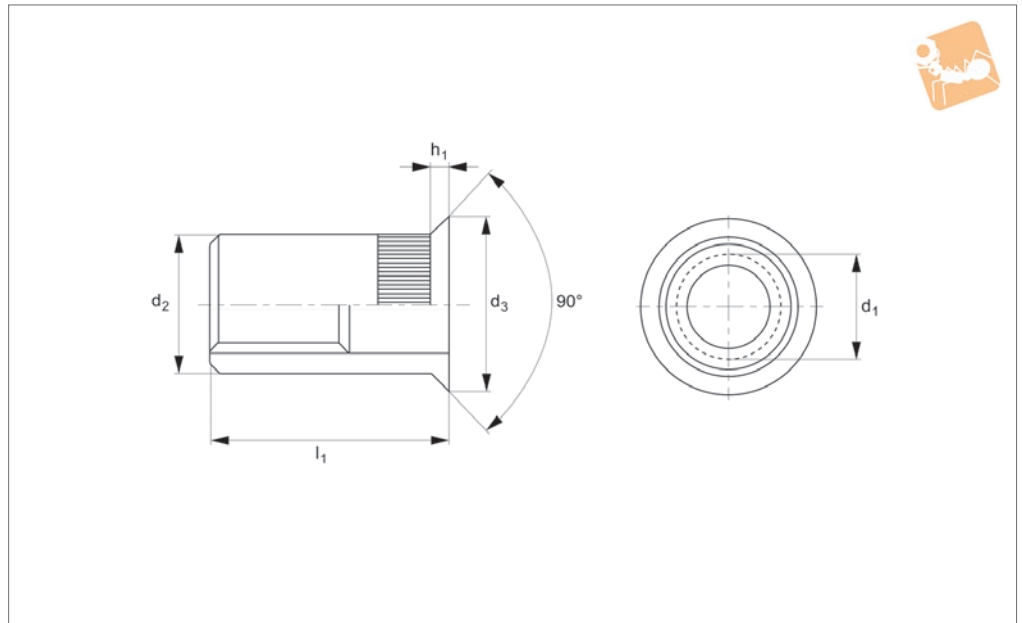

Material
Aluminium.

Technical Notes
Knurled body type, plain available on request.
The countersunk head is a stronger type of

head and will ensure a flush finish in a countersunk hole. The knurled body provides extra turning resistance.

Tips
Also known as blind rivet nuts or grip nuts.

Important Notes
Lip Height:
M3-M8: 0<1.5
M10: 1.5<1.7
M12: 1.7<1.9

Order No.	d ₁	Grip range	d ₂ +0 -0.2	d ₃	h ₁	l ₁
P0821.030-035-AL	M 3	1,5-3,5	4.9	7.5	1.5	11.5
P0821.030-045-AL	M 3	3,5-4,5	4.9	7.5	1.5	12.5
P0821.040-040-AL	M 4	1,5-4,0	5.9	8.5	1.5	12.5
P0821.040-055-AL	M 4	4,0-5,5	5.9	8.5	1.5	15.0
P0821.050-040-AL	M 5	1,5-4,0	6.9	9.5	1.5	13.5
P0821.050-065-AL	M 5	4,0-6,5	6.9	9.5	1.5	16.0
P0821.050-090-AL	M 5	6,5-9,0	6.9	9.5	1.5	18.5
P0821.060-040-AL	M 6	1,5-4,0	8.9	11.5	1.5	15.5
P0821.060-065-AL	M 6	4,0-6,5	8.9	11.5	1.5	18.0
P0821.060-090-AL	M 6	6,5-9,0	8.9	11.5	1.5	20.5
P0821.080-040-AL	M 8	1,5-4,0	10.9	13.5	1.5	18.5
P0821.080-065-AL	M 8	4,0-6,5	10.9	13.5	1.5	21.0
P0821.080-090-AL	M 8	6,5-9,0	10.9	13.5	1.5	23.5
P0821.100-045-AL	M10	2,0-4,5	11.9	14.5	1.7	21.0
P0821.100-075-AL	M10	4,5-7,5	11.9	14.5	1.7	24.0
P0821.100-105-AL	M10	7,5-10,5	11.9	14.5	1.7	27.0
P0821.120-045-AL	M12	2,0-4,5	15.9	19.0	1.9	24.5
P0821.120-075-AL	M12	4,5-7,5	15.9	19.0	1.9	27.5
P0821.120-105-AL	M12	7,5-10,5	15.9	19.0	1.9	31.0



Reduced C'snk Head Insert Nuts

Reduced - steel, zinc-plated

Insert Nuts

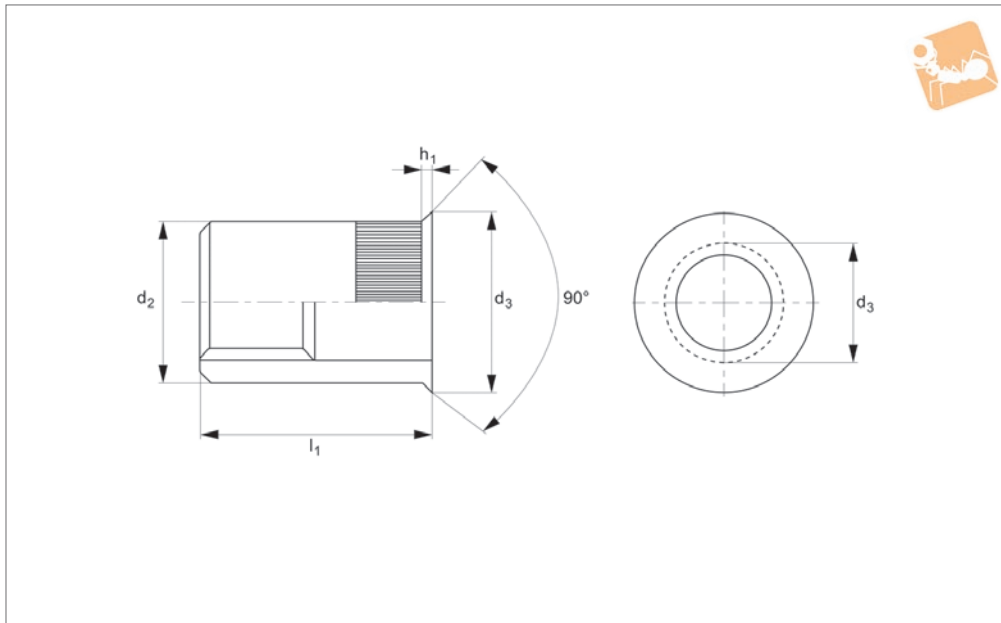

P0824.ZP

INSERT NUTS

Material

Steel, zinc-plated.

Technical Notes

Knurled body type, plain available on request.

Provides near flush installation in thin

materials.

The knurled body provides extra turning resistance.

Tips

Also known as blind rivet nuts or grip nuts.

Important Notes

Reduced height head.

M3-M8: 0<0.7

M10: 0.7<0.9

Order No.	d ₁	Grip range	d ₂ +0 -0.2	d ₃	h ₁	l ₁
P0824.030-020-ZP	M 3	0,5-2,0	4.9	6.0	0.5	9.0
P0824.040-025-ZP	M 4	0,5-2,5	5.9	6.7	0.5	11.3
P0824.040-040-ZP	M 4	2,0-4,0	5.9	7.0	0.5	13.0
P0824.050-030-ZP	M 5	0,5-3,0	6.9	8.0	0.5	12.0
P0824.050-040-ZP	M 5	2,0-4,0	6.9	8.0	0.5	13.0
P0824.060-030-ZP	M 6	0,5-3,0	8.9	10.0	0.6	14.0
P0824.060-045-ZP	M 6	2,5-4,5	8.9	10.0	0.6	16.0
P0824.080-038-ZP	M 8	0,5-3,8	10.9	12.0	0.6	17.3
P0824.080-050-ZP	M 8	3,0-5,0	10.9	12.0	0.6	18.5
P0824.100-035-ZP	M10	0,7-3,5	11.9	13.0	0.7	20.0
P0824.100-035A-ZP	M10	0,7-3,5	12.9	14.0	0.8	21.0
P0824.100-060-ZP	M10	3,5-6,0	12.9	14.0	0.8	22.0
P0824.120-035-ZP	M12	1,0-3,5	15.9	17.0	1.0	24.2



INSERT NUTS

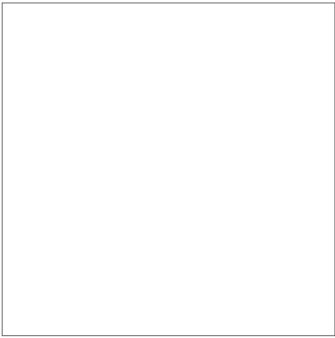

P0824.A4

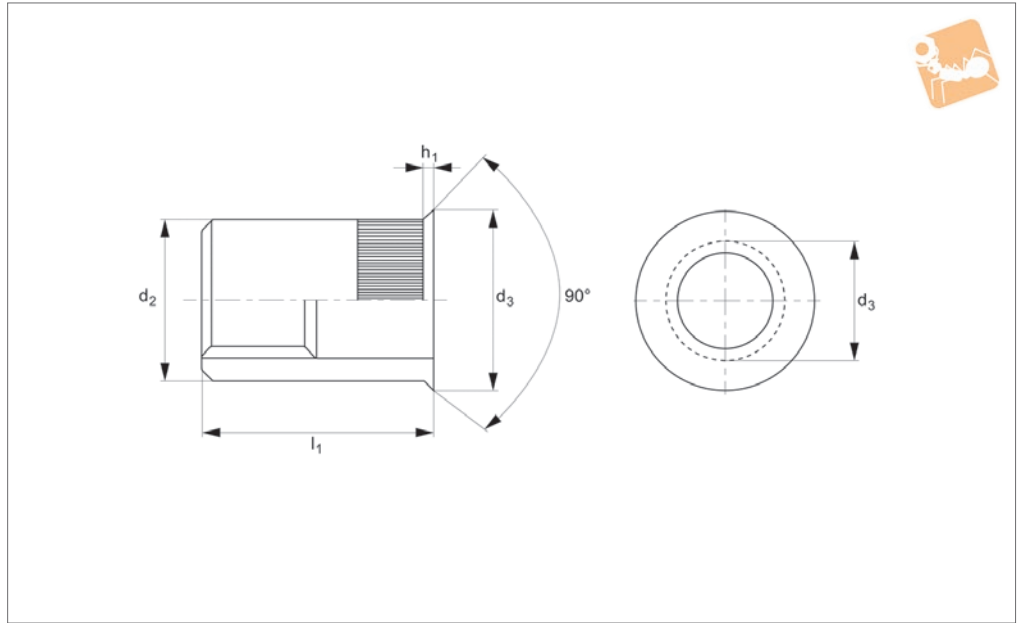

Material
Stainless steel (A4, AISI 316).

Provides near flush installation in thin materials.

Important Notes
Reduced height head.
M3-M8: 0<0.7
M10: 0.7<0.9

Technical Notes
Plain body type.

Tips
Also known as blind rivet nuts or grip nuts.

Order No.	d ₁	Grip range	d ₂ +0 -0.2	d ₃	h ₁	l ₁
P0824.040-020-A4	M 4	0,5-2,0	6.0	6.5	0.5	11.0
P0824.050-030-A4	M 5	0,5-3,0	7.0	7.5	0.5	12.0
P0824.060-030-A4	M 6	0,5-3,0	9.0	9.50	0.5	14.5
P0824.080-030-A4	M 8	0,5-3,0	11.0	11.5	0.5	16.0



Reduced C'snk Head Insert Nuts

Reduced - Aluminium

Insert Nuts

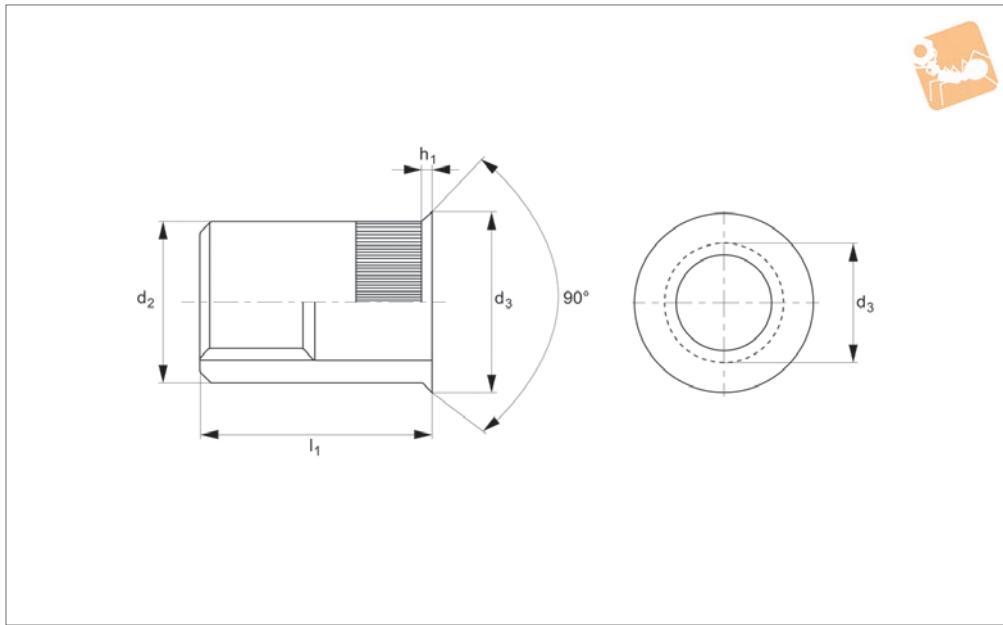

P0824.AL

INSERT NUTS

Material

Aluminium.

Technical Notes

Knurled body type, plain available on request.
Provides near flush installation in thin

materials.

The knurled body provides extra turning resistance.

Tips

Also known as blind rivet nuts or grip nuts.

Important Notes

Reduced height head.
M3-M8: 0<0.7
M10: 0.7<0.9

Order No.	d ₁	Grip range	d ₂ +0 -0.2	d ₃	h ₁	l ₁
P0824.030-025-AL	M3	0,5-2,5	4.9	6.0	0.6	9.5
P0824.040-030-AL	M4	0,5-3,0	5.9	7.0	0.6	10.0
P0824.050-030-AL	M5	0,5-3,0	6.9	8.0	0.6	11.5
P0824.060-030-AL	M6	0,5-3,0	8.9	10.0	0.6	14.0
P0824.080-030-AL	M8	0,5-3,0	10.9	12.0	0.6	15.5



P0823.A2

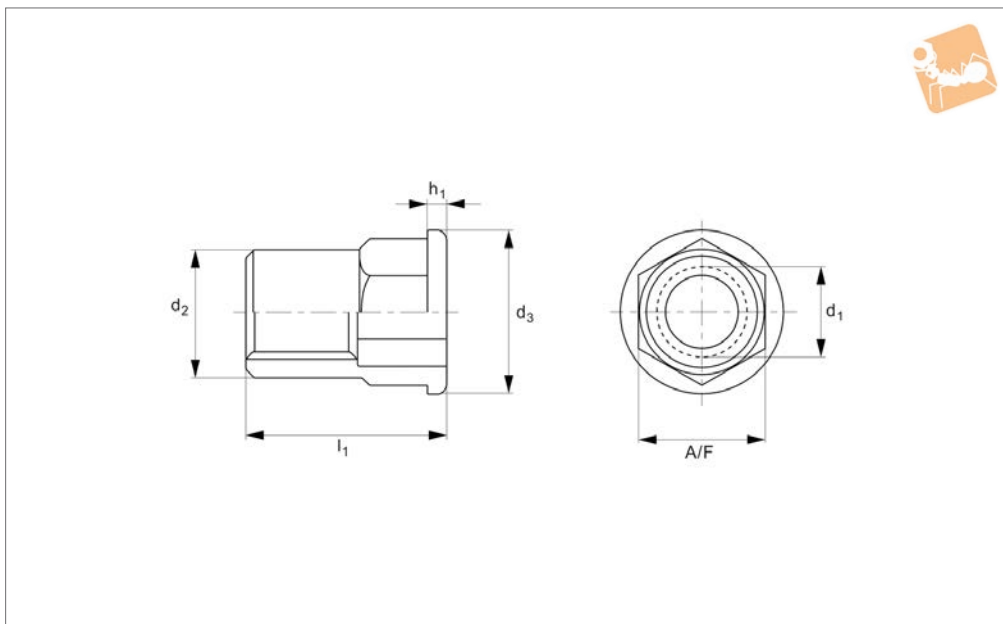

Material

Stainless steel (A2, AISI 303).

Technical Notes

Plain body type.
Hexagon body insert nuts prevent the

problem of a nut turning after being installed. Flange head insert nuts are recommended for use in load bearing applications. The larger sized head acts as a reinforcement to the hole, provides resi-

stance to push-out and acts as a spacer.

Tips

Also known as blind rivet nuts or grip nuts.

Order No.	d ₁	Grip range	A/F	d ₂	h ₁	l ₁
P0823.040-025-A2	M 4	0,5-2,5	6.0	9.0	1.0	11.5
P0823.050-030-A2	M 5	0,5-3,0	7.0	10.0	1.0	13.0
P0823.060-030-A2	M 6	0,5-3,0	9.0	12.0	1.5	15.5
P0823.080-030-A2	M 8	0,5-3,0	11.0	14.5	1.5	17.5
P0823.100-035-A2	M10	1,0-3,5	13.0	16.5	2.0	21.5



Flat Half Hex Insert Nuts

A4 stainless

Insert Nuts

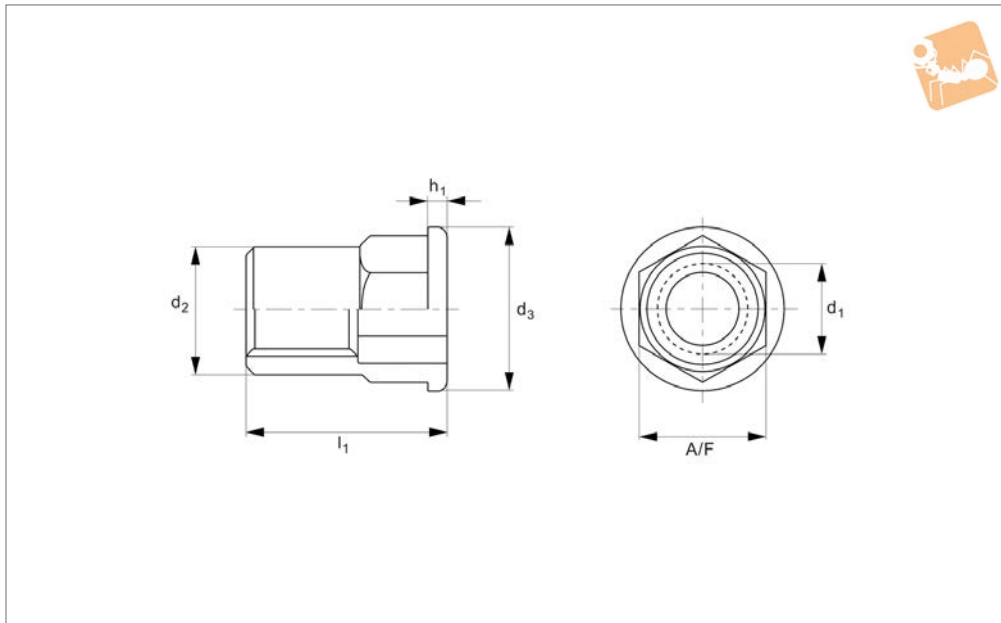

P0823.A4

INSERT NUTS

Material

Stainless steel (A4, AISI 316).

Technical Notes

Plain body type.

Hexagon body insert nuts prevent the

problem of a nut turning after being installed. Flange head insert nuts are recommended for use in load bearing applications. The larger sized head acts as a reinforcement to the hole, provides resi-

stance to push-out and acts as a spacer.

Tips

Also known as blind rivet nuts or grip nuts.

Order No.	d ₁	Grip range	A/F	d ₂	h ₁	l ₁
P0823.040-025-A4	M4	0,5-2,5	6.0	9.0	1.0	12.0
P0823.050-030-A4	M5	0,5-3,0	7.0	10.0	1.0	12.5
P0823.060-030-A4	M6	0,5-3,0	9.0	12.0	1.5	16.0
P0823.080-030-A4	M8	0,5-3,0	11.0	15.0	1.5	17.5