

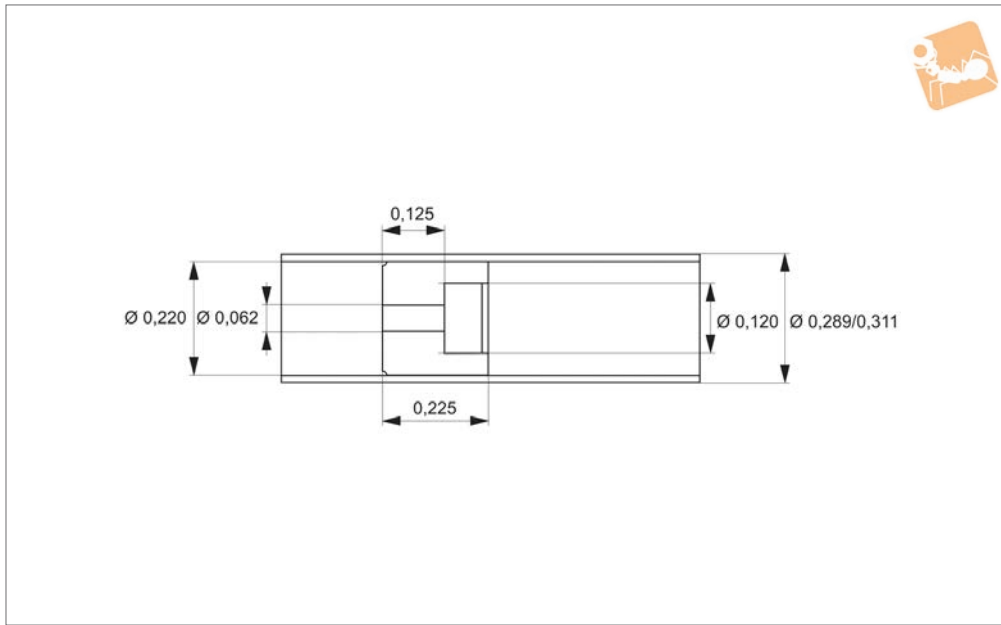

Cylinder / Piston Set

0,22" bore

Cylinders



L4630

CYLINDERS

Material

Piston: Carbon graphite
Cylinder: Glass

Technical Notes

Max operating temp = 260°C

Important Notes

Specials available on request.

Order No.	Stroke	Bore dia.	Outside dia.	Cylinder length	Piston length	Piston area in ²	Friction W/O sideload g	Cylinder weight g	Piston weight g
L4630.0500	0,5"	0.220	0.311	0,825"	0.225	0.038	< 1	1.39	0.20
L4630.1000	1,0"	0.220	0.311	1,325"	0.225	0.038	< 1	1.39	0.20
L4630.2000	2,0"	0.220	0.311	2,325"	0.225	0.038	< 1	1.39	0.20
L4630.3000	3,0"	0.220	0.311	3,325"	0.225	0.038	< 1	1.39	0.20
L4630.4000	4,0"	0.220	0.311	4,325"	0.225	0.038	< 1	1.39	0.20
L4630.5000	5,0"	0.220	0.311	5,325"	0.225	0.038	< 1	1.39	0.20
L4630.6000	6,0"	0.220	0.311	6,325"	0.225	0.038	< 1	1.39	0.20
L4630.7000	7,0"	0.220	0.311	7,325"	0.225	0.038	< 1	1.39	0.20
L4630.8000	8,0"	0.220	0.311	8,325"	0.225	0.038	< 1	1.39	0.20



L4632

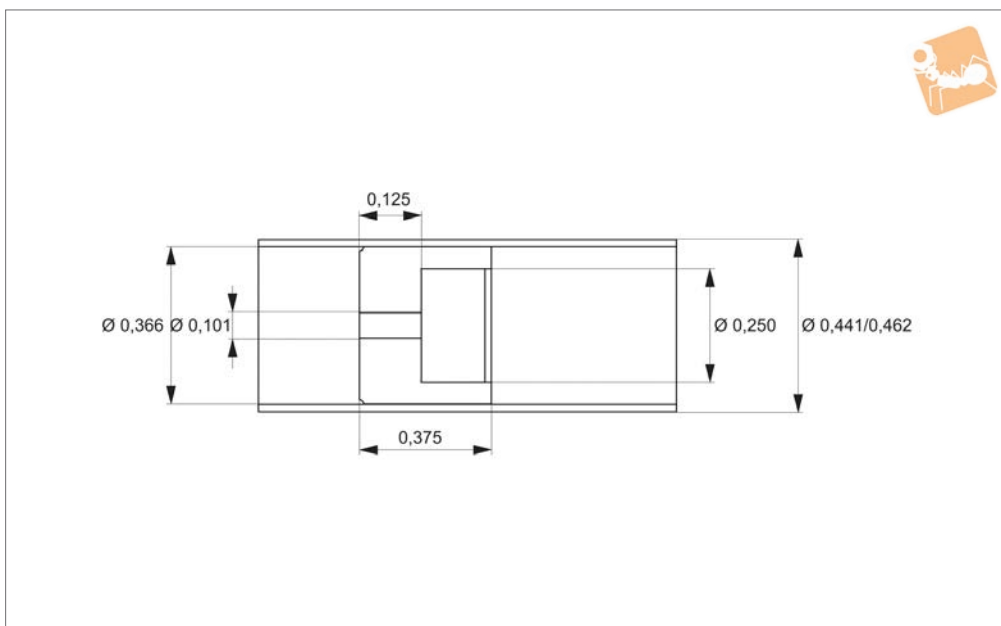

Material

Piston: Carbon graphite
Cylinder: Glass

Technical Notes

Max operating temp = 260°C

Important Notes

Specials available on request.

Order No.	Stroke	Bore dia.	Outside dia.	Cylinder length	Piston length	Piston area in ²	Friction w/o sideload g	Cylinder weight g	Piston weight g
L4632.0500	0,5"	0.336	0.462	0,975"	0.375	0.105	< 1	2.29	0.77
L4632.1000	1,0"	0.336	0.462	1,475"	0.375	0.105	< 1	2.29	0.77
L4632.2000	2,0"	0.336	0.462	2,475"	0.375	0.105	< 1	2.29	0.77
L4632.3000	3,0"	0.336	0.462	3,475"	0.375	0.105	< 1	2.29	0.77
L4632.4000	4,0"	0.336	0.462	4,475"	0.375	0.105	< 1	2.29	0.77
L4632.5000	5,0"	0.336	0.462	5,475"	0.375	0.105	< 1	2.29	0.77
L4632.6000	6,0"	0.336	0.462	6,475"	0.375	0.105	< 1	2.29	0.77
L4632.7000	7,0"	0.336	0.462	7,475"	0.375	0.105	< 1	2.29	0.77
L4632.8000	8,0"	0.336	0.462	8,475"	0.375	0.105	< 1	2.29	0.77



Cylinder / Piston Set

0,627" bore

Cylinders

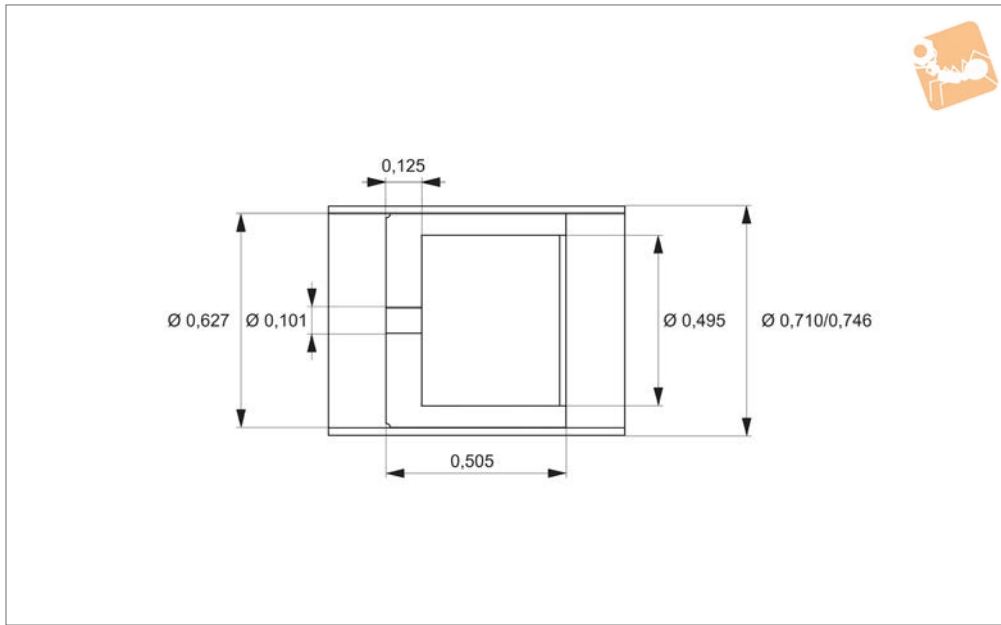

L4634

CYLINDERS

Material

Piston: Carbon graphite
Cylinder: Glass

Technical Notes

Max operating temp = 260°C

Important Notes

Specials available on request.

Order No.	Stroke	Bore dia.	Outside dia.	Cylinder length	Piston length	Piston area in ²	Friction W/O sideload g	Cylinder weight g	Piston weight g
L4634.0500	0,5"	0,627	1,246"	0,605	0,505	0,309	< 1	4,71	2,37
L4634.1000	1,0"	0,627	1,746"	0,605	0,505	0,309	< 1	4,71	2,37
L4634.2000	2,0"	0,627	2,746"	0,605	0,505	0,309	< 1	4,71	2,37
L4634.3000	3,0"	0,627	3,746"	0,605	0,505	0,309	< 1	4,71	2,37
L4634.4000	4,0"	0,627	4,746"	0,605	0,505	0,309	< 1	4,71	2,37
L4634.5000	5,0"	0,627	5,746"	0,605	0,505	0,309	< 1	4,71	2,37
L4634.6000	6,0"	0,627	6,746"	0,605	0,505	0,309	< 1	4,71	2,37
L4634.7000	7,0"	0,627	7,746"	0,605	0,505	0,309	< 1	4,71	2,37
L4634.8000	8,0"	0,627	8,746"	0,605	0,505	0,309	< 1	4,71	2,37



L4636

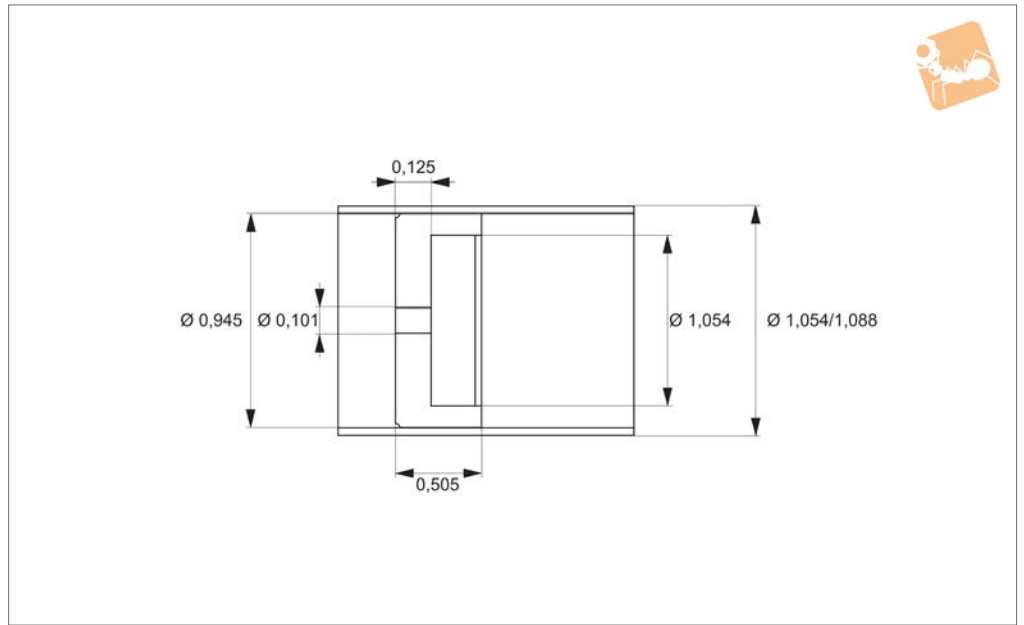

Material

Piston: Carbon graphite
Cylinder: Glass

Technical Notes

Max operating temp = 260°C

Important Notes

Specials available on request.

Order No.	Stroke	Bore dia.	Outside dia.	Cylinder length	Piston length	Piston area in ²	Friction w/o sideload g	Cylinder weight g	Piston weight g
L4636.0500	0,5"	0.945	1.088	1,105"	0.505	0.701	< 1	8.39	4.66
L4636.1000	1,0"	0.945	1.088	1,605"	0.505	0.701	< 1	8.39	4.66
L4636.2000	2,0"	0.945	1.088	2,605"	0.505	0.701	< 1	8.39	4.66
L4636.3000	3,0"	0.945	1.088	3,605"	0.505	0.701	< 1	8.39	4.66
L4636.4000	4,0"	0.945	1.088	4,605"	0.505	0.701	< 1	8.39	4.66
L4636.5000	5,0"	0.945	1.088	5,605"	0.505	0.701	< 1	8.39	4.66
L4636.6000	6,0"	0.945	1.088	6,605"	0.505	0.701	< 1	8.39	4.66
L4636.7000	7,0"	0.945	1.088	7,605"	0.505	0.701	< 1	8.39	4.66
L4636.8000	8,0"	0.945	1.088	8,605"	0.505	0.701	< 1	8.39	4.66



Cylinder / Piston Set

1,281" bore

Cylinders

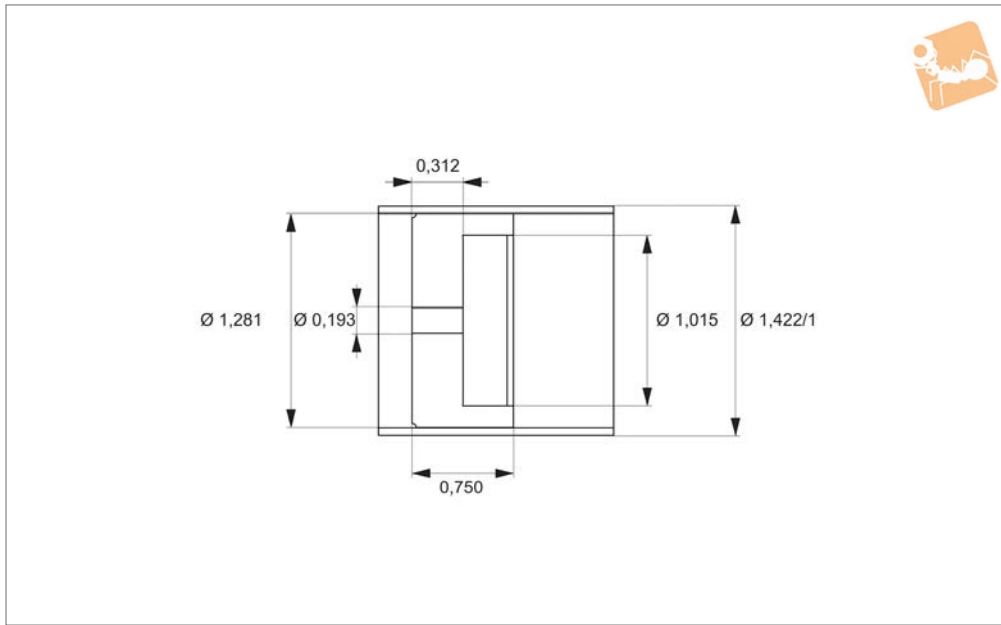

L4638

CYLINDERS

Material

Piston: Carbon graphite
Cylinder: Glass

Technical Notes

Max operating temp = 260°C

Important Notes

Specials available on request.

Order No.	Stroke	Bore dia.	Outside dia.	Cylinder length	Piston length	Piston area in ²	Friction W/O sideload g	Cylinder weight g	Piston weight g
L4638.0500	0,5"	1.281	1.456	1,350"	0.750	1.289	< 1	13.82	17.75
L4638.1000	1,0"	1.281	1.456	1,850"	0.750	1.289	< 1	13.82	17.75
L4638.2000	2,0"	1.281	1.456	2,850"	0.750	1.289	< 1	13.82	17.75
L4638.3000	3,0"	1.281	1.456	3,850"	0.750	1.289	< 1	13.82	17.75
L4638.4000	4,0"	1.281	1.456	4,850"	0.750	1.289	< 1	13.82	17.75
L4638.5000	5,0"	1.281	1.456	5,850"	0.750	1.289	< 1	13.82	17.75
L4638.6000	6,0"	1.281	1.456	6,850"	0.750	1.289	< 1	13.82	17.75
L4638.7000	7,0"	1.281	1.456	7,850"	0.750	1.289	< 1	13.82	17.75
L4638.8000	8,0"	1.281	1.456	8,850"	0.750	1.289	< 1	13.82	17.75



L4640

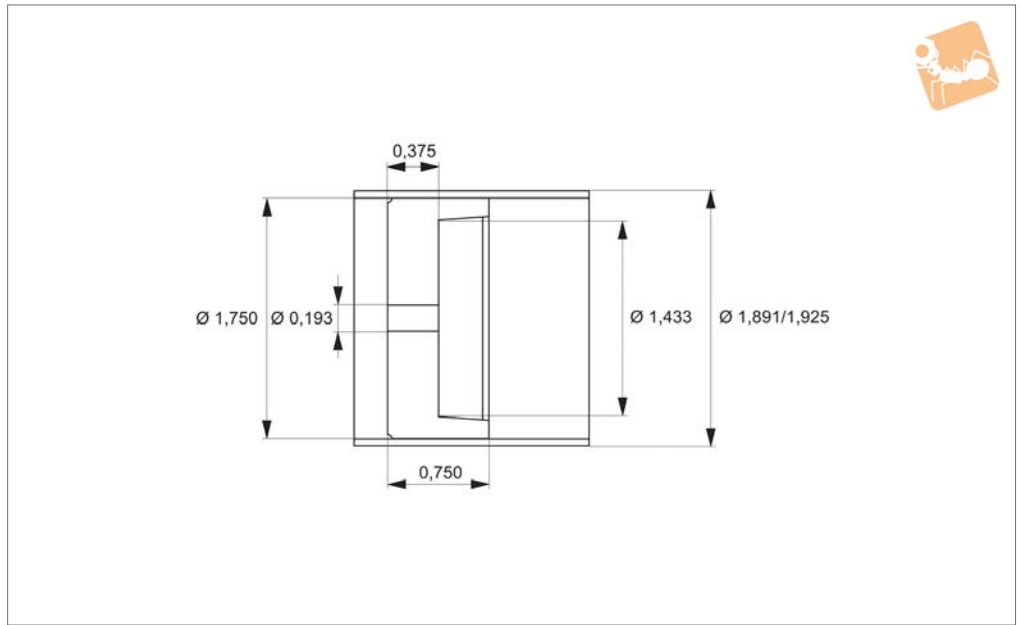

Material

Piston: Carbon graphite
Cylinder: Glass

Technical Notes

Max operating temp = 260°C

Important Notes

Specials available on request.

Order No.	Stroke	Bore dia.	Outside dia.	Cylinder length	Piston length	Piston area in ²	Friction w/o sideload g	Cylinder weight g	Piston weight g
L4640.0500	0,5"	1.750	1.925	1.350	0.750	2.406	< 1	18.56	34.60
L4640.1000	1,0"	1.750	1.925	1.850	0.750	2.406	< 1	18.56	34.60
L4640.2000	2,0"	1.750	1.925	2.850	0.750	2.406	< 1	18.56	34.60
L4640.3000	3,0"	1.750	1.925	3.850	0.750	2.406	< 1	18.56	34.60
L4640.4000	4,0"	1.750	1.925	4.850	0.750	2.406	< 1	18.56	34.60
L4640.5000	5,0"	1.750	1.925	5.850	0.750	2.406	< 1	18.56	34.60
L4640.6000	6,0"	1.750	1.925	6.850	0.750	2.406	< 1	18.56	34.60
L4640.7000	7,0"	1.750	1.925	7.850	0.750	2.406	< 1	18.56	34.60
L4640.8000	8,0"	1.750	1.925	8.850	0.750	2.406	< 1	18.56	34.60