

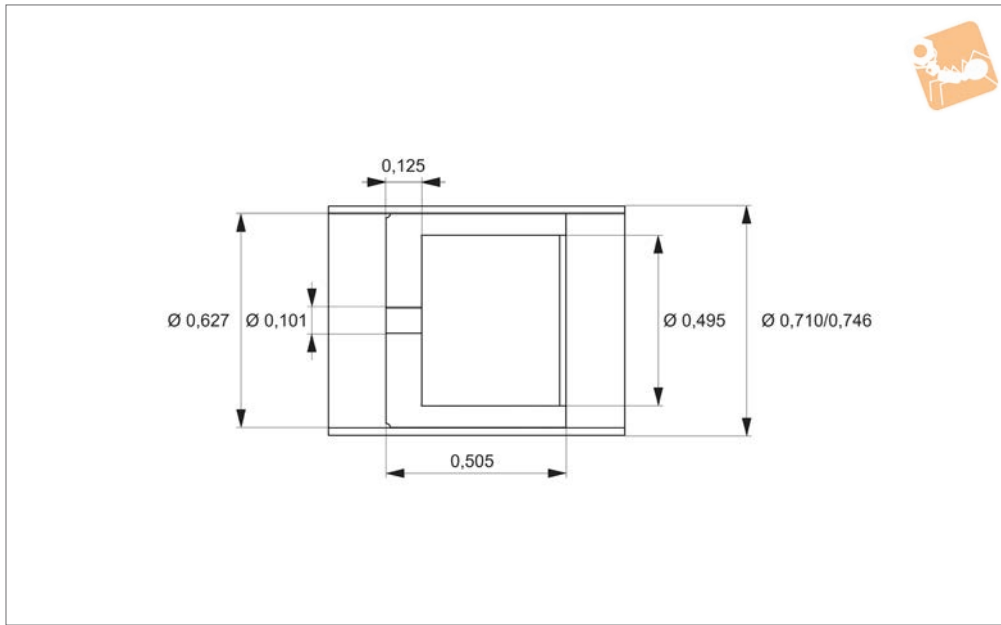

Cylinder / Piston Set

0,627" bore

Cylinders



L4634

CYLINDERS

Material

Piston: Carbon graphite
Cylinder: Glass

Technical Notes

Max operating temp = 260°C

Important Notes

Specials available on request.

Order No.	Stroke	Bore dia.	Outside dia.	Cylinder length	Piston length	Piston area in ²	Friction W/O sideload g	Cylinder weight g	Piston weight g
L4634.0500	0,5"	0,627	1,246"	0,605	0,505	0,309	< 1	4,71	2,37
L4634.1000	1,0"	0,627	1,746"	0,605	0,505	0,309	< 1	4,71	2,37
L4634.2000	2,0"	0,627	2,746"	0,605	0,505	0,309	< 1	4,71	2,37
L4634.3000	3,0"	0,627	3,746"	0,605	0,505	0,309	< 1	4,71	2,37
L4634.4000	4,0"	0,627	4,746"	0,605	0,505	0,309	< 1	4,71	2,37
L4634.5000	5,0"	0,627	5,746"	0,605	0,505	0,309	< 1	4,71	2,37
L4634.6000	6,0"	0,627	6,746"	0,605	0,505	0,309	< 1	4,71	2,37
L4634.7000	7,0"	0,627	7,746"	0,605	0,505	0,309	< 1	4,71	2,37
L4634.8000	8,0"	0,627	8,746"	0,605	0,505	0,309	< 1	4,71	2,37