

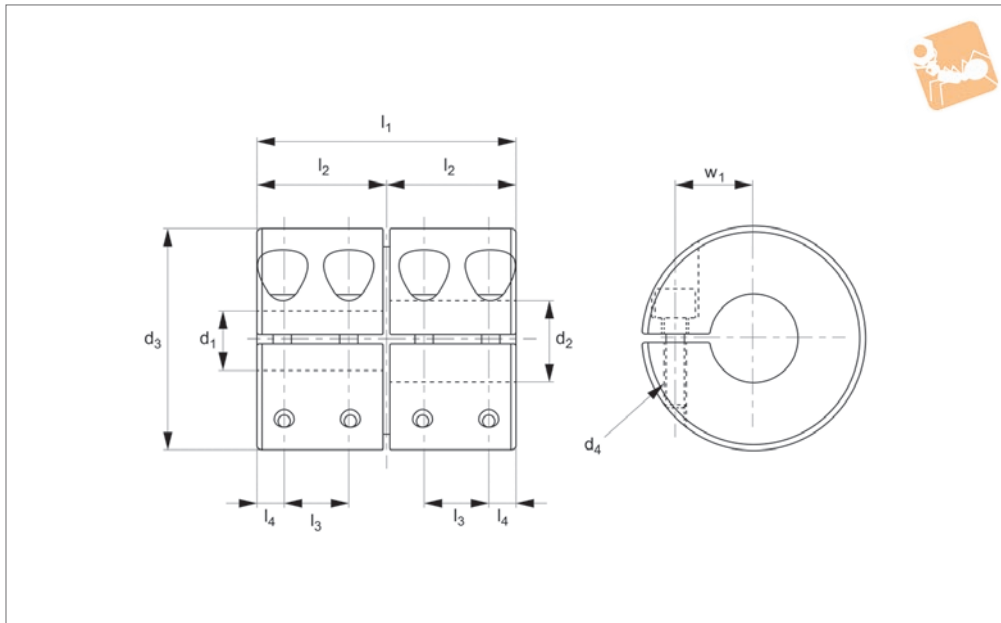

# Rigid Shaft Coupling - One Piece

Stainless, clamping, long

## Rigid Couplings

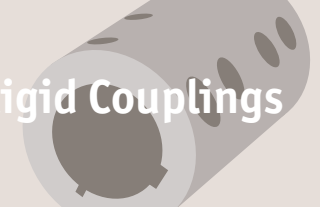

**R3203**

RIGID COUPLINGS

### Material

Stainless steel (A2).

### Technical Notes

Beam type with minimal allowable offset.  
Maintenance free, excellent anti-oil and

corrosion resistance.

Reciprocating torque is quarter static torque.

Rotational torque is half static torque.

### Important Notes

Different bore sizes available on request.  
Keyways are standard to DIN 6885.  
See keyway technical pages.

Order No.	d <sub>1</sub> tol. H7/H8	d <sub>2</sub> tol. H7/H8	d <sub>3</sub>	d <sub>4</sub>	l <sub>1</sub>	l <sub>2</sub>	l <sub>3</sub>	w	Static torque Nm	rpm max.	Moment of inertia kg·m <sup>2</sup>	Torque screw to Nm	Weight g
R3203.16-05-05	5	5	16	M 2	22	2,5	5,5	5	0,6	9000	8,9x10 <sup>-7</sup>	0,5	25
R3203.16-05-06	5	6	16	M 2	22	2,5	5,5	5	0,6	9000	8,9x10 <sup>-7</sup>	0,5	25
R3203.16-06-06	6	6	16	M 2	22	2,5	5,5	5	0,6	9000	8,9x10 <sup>-7</sup>	0,5	25
R3203.20-06-06	6	6	20	M 2	24	2,5	6,0	7	1	7000	2,5x10 <sup>-6</sup>	0,5	45
R3203.20-06-08	6	8	20	M 2	24	2,5	6,0	7	1	7000	2,5x10 <sup>-6</sup>	0,5	45
R3203.20-08-08	8	8	20	M 2	24	2,5	6,0	7	1	7000	2,5x10 <sup>-6</sup>	0,5	45
R3203.25-08-08	8	8	25	M2,5	36	4,5	9,0	9	2	6000	9,2x10 <sup>-6</sup>	1,0	100
R3203.25-08-10	8	10	25	M2,5	36	4,5	9,0	9	2	6000	9,2x10 <sup>-6</sup>	1,0	100
R3203.25-10-10	10	10	25	M2,5	36	4,5	9,0	9	2	6000	9,2x10 <sup>-6</sup>	1,0	100
R3203.32-10-10	10	10	32	M 3	40	4,0	10,0	11	4	4500	2,7x10 <sup>-5</sup>	1,5	180
R3203.32-10-12	10	12	32	M 3	40	4,0	10,0	11	4	4500	2,7x10 <sup>-5</sup>	1,5	180
R3203.32-10-14	10	14	32	M 3	40	4,0	10,0	11	4	4500	2,7x10 <sup>-5</sup>	1,5	180
R3203.32-12-12	12	12	32	M 3	40	4,0	10,0	11	4	4500	2,7x10 <sup>-5</sup>	1,5	180
R3203.32-12-14	12	14	32	M 3	40	4,0	10,0	11	4	4500	2,7x10 <sup>-5</sup>	1,5	180
R3203.32-14-14	14	14	32	M 3	40	4,0	10,0	11	4	4500	2,7x10 <sup>-5</sup>	1,5	180